



10th June 2020

Dear Parent/Carer,

I am writing to explain our continued plans for remote learning and future plans to reopen the school to Year 10 pupils from 15th June in accordance with the government guidance. The latest government guidance can be found here:

<https://www.gov.uk/government/publications/preparing-for-the-wider-opening-of-schools-from-1-june/planning-guide-for-secondary-schools>

Year 10 Educational Offer Supplementary to Remote Learning

We are planning to offer face-to-face sessions to supplement the remote learning of our Year 10 pupils in school for limited numbers of pupils at any given time. The normal remote learning programme will continue in addition to the sessions described below. We are not permitted to have more than one quarter of the year group on site on any one day, therefore we have prepared a timetable to facilitate this in a safe way for all. These sessions will be educationally beneficial, an opportunity to check on pupil's well-being and discuss how we can further support your child in accessing the remote learning programme currently in operation. The school recognises that not every pupil will be able to attend and accepts that some parents may prefer that their child does not attend face to face sessions in school at this time. All pupils will continue to receive support via the remote learning opportunities and the daily contact with teachers and pastoral staff. The government guidance will be continually reviewed alongside changing pupil needs.

The intention is to run a two-week timetable where your child will be given the opportunity to attend various 2 hour sessions with their subject teachers in core and option classes. The purpose of the sessions are to review their current performance, address any concerns, answer any queries and support their learning.

The core subjects of English, Maths and Science, are taught in A and B bands within the school. Your child will know which category they fit into. Sessions will be available for the A band core subject classes (Science, Maths, English) on a Mon-Wed respectively during red week 1 and B band core classes blue week 2. This will continue to alternate for the remainder of the term. Pupils are taught in option bands A,B,C, and D. Pupils will be aware which teacher they have and their timetable will show which block they are in. Option classes will run on a two-week cycle Option A classes on red Thursday, Option B on blue Thursday, Option C red Friday and option D blue Friday.
(Refer to attached timetable plan)

In order for us to ensure we restrict numbers in school at any one time to 25% of the cohort, it is important that pupils only attend the sessions as requested. We would appreciate your cooperation in confirming in

RESPECT • ASPIRATION • DETERMINATION • INDEPENDENCE



advance whether you intend to access the face-to-face provision so we can coordinate a fair and safe rotation of pupils/staff.

The first parental survey regarding intentions to send Yr 10 pupils in to school indicated a 50% split between those choosing to send their child in to school and those that have opted against doing so. We would appreciate parents completing the current survey attached to indicate which specific sessions they wish to opt into, now that firm plans are in place.

<https://www.surveymonkey.co.uk/r/10SurveySubjects>

This survey will allow us to plan for restricted numbers. Where anticipated numbers are higher than originally expected your child will be given a specific date they are required to attend. Subject teachers will make contact with pupils via Google Classrooms to confirm attendance and time slots.

Safety, Standards and expectations

The safety of pupils and teachers is at the centre of our plans. The following procedures are in place to allow the pupils to be in school safely.

- Yr10 Pupils should only attend for specific confirmed timetabled sessions unless already participating in key worker and vulnerable provision
- Pupils must arrive punctually, the gates will be closed once sessions start
- Pupils must enter and exit via the designated gates outlined in the plan, they are advised to travel to and from school adhering to social distancing rules
- If travelling on public transport pupils should wear face coverings and maintain social distancing rules
- For pupil drop off/pick up, parents/carers should remain in their cars in order to minimise contact with others. Pupils arriving at school should go straight to their classrooms observing the clearly displayed circulation and social-distancing signs
- Pupils should present wearing modified school uniform: White shirt, school trousers/skirt and school shoes (not trainers). Blazers and ties are not necessary at this time. All normal rules regarding make up, hairstyles, jewellery apply
- Pupils should filter into school using 2 m distancing markings set out prior to entry as they approach
- Staff will be assigned a gate duty to monitor and supervise pupil entry and exit checking standards and expectations
- Pupils to go directly to designated classrooms maintaining 2m social distancing in single file lanes keeping to the left hand side of the corridors
- Pupils will sit in seating plan order as directed by teaching staff
- Pupils will be at a distance of at least 2m from other pupils and from the teachers. This will be achieved by using small class sizes and our largest rooms
-

RESPECT • ASPIRATION • DETERMINATION • INDEPENDENCE



- Pupils will need to bring all their own equipment: water bottles, pens, pencils, rulers, rubbers and books to prevent items being shared. Pupils must not borrow from other pupils
- Pupils to follow revised behaviour policy, expectations will be reinforced at the start of each session.

<https://www.reddish.stockport.sch.uk/news/?pid=7&nid=15&storyid=400>

- Teachers will teach pupils from the front of the rooms and will not circulate amongst the pupils
- Pupils requiring the toilet during the day will follow the supervised toilet plan
- Pupils will move in a controlled fashion around the school, keeping to the left when moving around the main corridors, travelling single file and following one-way systems for narrower corridors
- The school day has been restricted to 2 hours to avoid managing the complexities of supervising break or lunch arrangements. Lunch will not be provided in school. Free school meal vouchers will continue to be provided for those eligible
- The school has ample supplies of soap to allow regular hand-washing and sanitiser is provided outside every room
- The work stations will be cleaned at the end of each session
- Pupils who show any symptoms consistent with Coronavirus or who live with someone showing symptoms must not come to school
- If a pupil has an allergy or other condition that might cause them to cough during their time in school then we would be most grateful if you would provide them with tissues to cough into safely and also let us know to avoid possible confusion with the symptoms of Coronavirus
- Any pupil who does not abide by the social distancing and other procedures will be isolated and sent home
- Any pupil who begins to display Coronavirus symptoms while in the setting will be seen by the school First Aid Officer. Parent/carers will then be asked to collect the pupil immediately or give consent for them to return home and follow government guidelines on what to do if you or someone in your household develops symptoms. If a pupil is waiting to be collected, they will be looked after in a safe environment. A facemask will be worn if a distance of 2 metres cannot be maintained from a pupil who is symptomatic and awaiting collection and, if contact is necessary, then gloves, an apron and a facemask will also be worn. In this situation we would ask parents/carers to organise a test for their son or daughter: <https://www.gov.uk/guidance/coronavirus-covid-19-getting-tested> . We would ask the parent/carer to notify us immediately of a positive test result in order that we can advise the parents/carer of any pupils who may have come into contact with the pupil who has tested positive
- The pastoral team have been maintaining communication and offering support to pupils remotely. Please advise the year team of any changes regarding your child's welfare, health and wellbeing that we should be aware of before their return to school
- Pupils not involved in teaching sessions should not be on site and pupils should return home immediately after the session

RESPECT • ASPIRATION • DETERMINATION • INDEPENDENCE



- Staff will have been briefed and trained through an Inset session
- In the event of a Fire evacuation, Yr 10 pupils will be escorted to the front field by their class teacher in single file 2m distanced lines. Registers will be completed while classes line up 2 metres apart
- A detailed risk assessment has been produced and is published on the school website

<https://www.reddish.stockport.sch.uk/news/?pid=7&nid=15&storyid=401>

Even if you replied to the previous survey, please can we ask that you reply again, confirming attendance to the new schedule.

<https://www.surveymonkey.co.uk/r/10SurveySubjects>

Online Learning

Our Google Classroom platform has been up and running since the beginning of lockdown and teaching staff have been setting tasks and marking accordingly. We now need to step up engagement and based on our recent reporting, engagement requires improvement particularly in Years 9 and 10.

At this stage, we are unclear as to what formal examinations will take for our Yr 10 pupils next year. Therefore, it is vitally important that we can evidence the engagement rates and quality of work pupils are producing during these difficult times and in the future. Progress and performance data is gathered through a combination of ongoing assessments and end of unit test and exams. We would welcome your support in encouraging your child to maintain a strong work ethic and make every attempt to complete work set to the best of their ability. Subject teachers are continuing to provide feedback and support should your child need additional support.

Moving forwards we are asking pupils (where technology allows this) to have signed into the online Google Classroom by 9:30am at the latest each day. Year teams will then be able to keep you informed of when this has/has not happened so that you are more aware that your child's education is continuing throughout these challenging times.

To further build on this, we will be making some changes to incorporate live lessons, this could be in the form of live interaction on Google Classroom or via live stream lessons on Zoom. So that this works effectively, we will inform you of which sessions will be running as live lessons and where necessary, login details and instructions will be sent in advance. So that these sessions run smoothly and safely, pupils must attend where technology allows and in terms of safeguarding, staff will be trained on running sessions, all pupils will be muted upon arrival, will be encouraged to dress appropriately and take part responsibly in the lesson.

RESPECT • ASPIRATION • DETERMINATION • INDEPENDENCE



We have trialled and tested an excellent platform called Century Tech for English, Maths and Science. We hope to include other subjects as this becomes more developed. Century Tech identifies gaps in knowledge and misconceptions and builds a personalised learning path for every learner, tailored to their needs.

Identifying these knowledge gaps and remedying misconceptions. This really is a cutting edge platform and will provide our teachers a real insight into what pupils do and don't know.

Thank you for your continued support and cooperation. We will keep you updated regarding any further developments or plans.

Yours sincerely,

L. Hanson

Linda Hanson
Headteacher

RESPECT • ASPIRATION • DETERMINATION • INDEPENDENCE

Reddish Vale Road, Reddish, Stockport, Cheshire. SK5 7HD
Telephone: 0161 477 3544 Facsimile: 0161 429 9683
E-mail: admin@reddish.stockport.sch.uk www.reddish.stockport.sch.uk

Yr 10 Timetable Face to Face sessions

| Day | 10-12 AM | Venue |
|-----------|--|---|
| Monday | Science A Band Week 1 Science B Band Week 2 | Maths Rooms |
| Tuesday | Maths A Band Week 1 Maths B Band Week 2 | Maths |
| Wednesday | English A Band Week 1 English B Band Week 2 | Maths |
| Thursday | Week 1 Option A (1/2 class Confirmed attendance) Week 2 Option B (1/2 class Confirmed attendance) | Maths rooms with some option classrooms |
| Friday | Week 1 Option C (1/2 class Confirmed attendance) Week 2 Option D (1/2 class Confirmed attendance) | Maths rooms with some option classrooms |

Week 1 Red week- 15th June, 29th June, 13th July

| Room | Monday Class/Teacher | Tuesday Class/Teacher | Wednesday Class/Teacher | Thursday Option A | Friday Option C |
|------|----------------------|-----------------------|-------------------------|-----------------------|--------------------|
| MA1 | 10aSC1 B Charles | 10aM1 J Murphy | 10Ae1 C Eyres | Health & Soc C Sutton | T&T J Edwards |
| MA2 | 10aSC2 R Spencer | 10aM2 S Hodgson | 10aE2 J King Fahey | Art N Scholes | T&T M Power |
| MA3 | 10aSC3 M Dronsfield | 10aM3 B Matthews | 10aE3 L Garnett | Bus G Vickers 1 | Music E Durici |
| MA4 | 10aSC4 S Powell | 10aM4 R Hall | 10aE4 S Watts | Dance C Evans | History C Travis |
| MA5 | 10aSC1 L Olijnyk | 10aM1 T Shave | 10Ae1 J Taylor | Citz 1 L Hoyles | History B Foyle |
| MA6 | 10aSC2 K Evans | 10aM2 S Horne | 10aE2 S Williams | Citz 2 F Rockey | Geog W Denby |
| MA7 | 10aSC3 M Schwartz | 10aM3 S Cooke | 10aE3 S Brown | Hosp & Cat C Ellis | Geog T Robinson |
| MFL1 | 10aSC4 S Powell | 10aM4 C Cox | 10aE4 C Forsyth | PE Exam G McLelland | French C Papper |
| MFL2 | | | J Whitehouse | Sport E Riley | French A Harris |
| MFL3 | | | R Gibson | | German S Martin |
| MFL4 | | | K Bourne | | German M Whoriskey |

RESPECT • ASPIRATION • DETERMINATION • INDEPENDENCE



PERSONAL GROWTH ACADEMIC EXCELLENCE

Week 2 Blue week- 22nd June, 6th July

| Room | Monday | | | | | Tuesday | | | Wednesday | | | Thursday Option B | | | Friday Option D | | |
|---------------------|---------------------|-------|------|------|------|------------------|------|------|--------------------|-------|------|------------------------|--|--|-------------------------|--|--|
| MA1 | 10bSc1 B Charles | | | | | 10bM1 B Matthews | | | 10bE1 J Taylor | | | Citizenship J Edwards | | | Art N Scholes | | |
| MA2 | 10bSc2 L Olijnyk | | | | | 10bM2 T S have | | | 10bE2 S Williams | | | Geog W Denby | | | Support Group C Ellis | | |
| MA3 | 10bSc3 R Spencer | | | | | 10bM3 S Horne | | | 10bE3 R Gibson | | | Drama S Frith | | | Business R Miskell | | |
| MA4 | 10bSc1 K Evans | | | | | 10bM1 R Hall | | | 10bE1 C Eyres | | | PE Exam E Riley | | | Music A scholes | | |
| MA5 | 10bSc2 M Schwartz | | | | | 10bM2 S Hodgson | | | 10bE2 C Forsyth | | | Art G Bebb | | | Religious Stud L Hoyles | | |
| MA6 | 10bSc3 M Dronsfield | | | | | 10bM3 J Murphy | | | 10bE3 J King Fahey | | | History C Travis | | | Geog T Robinson | | |
| MA7 | S Powell | | | | | | | | S Brown | | | History A Lees | | | H&S CSU 15 | | |
| Bs1 | | | | | | | | | J Whitehouse | | | Creat imedia G Vickers | | | Creat imedia G Vickers | | |
| MFL3 | | | | | | | | | S Watts | | | Creat imedia A Harrop | | | Computing A Harrop | | |
| Room | MA1 | MA2 | MA3 | MA4 | MA5 | MA6 | MA7 | Bs1 | MFL1 | MFL2 | MFL3 | MFL4 | | | | | |
| Entry and exit gate | Front | Front | Side | Side | Side | Back | Back | Back | Front | Front | Back | Back | | | | | |

RESPECT • ASPIRATION • DETERMINATION • INDEPENDENCE

Reddish Vale Road, Reddish, Stockport, Cheshire. SK5 7HD
 Telephone: 0161 477 3544 Facsimile: 0161 429 9683
 E-mail: admin@reddish.stockport.sch.uk www.reddish.stockport.sch.uk

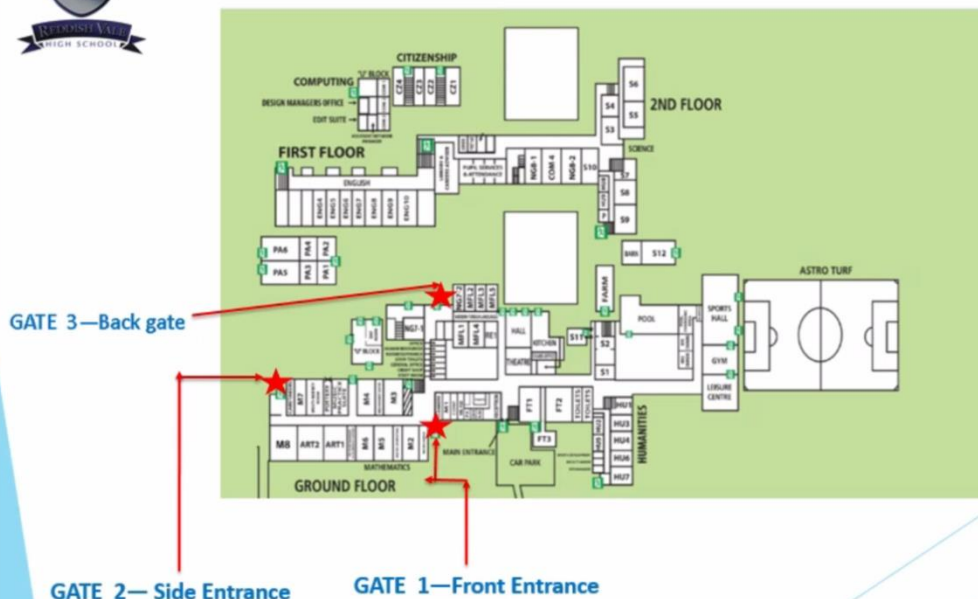

RESPECT • ASPIRATION • DETERMINATION • INDEPENDENCE

Reddish Vale Road, Reddish, Stockport, Cheshire. SK5 7HD
Telephone: 0161 477 3544 Facsimile: 0161 429 9683
E-mail: admin@reddish.stockport.sch.uk www.reddish.stockport.sch.uk